



27 Alfred Close, London, Chiswick, W4 5UW

Ideally located in the heart of Chiswick, this stunning two bedroom ground floor flat boasts a modern interior and is close to transport links and local amenities of Chiswick High Road and Turnham Green Terrace.

- Two bedrooms
- Ground floor
- Off-street allocated parking
- Purpose built
- Entirely refurbished
- Close to transport links
- Chain free
- Heart of Chiswick

£525,000

Alfred Close

Approximate Gross Internal Area
678 sq ft - 63 sq m

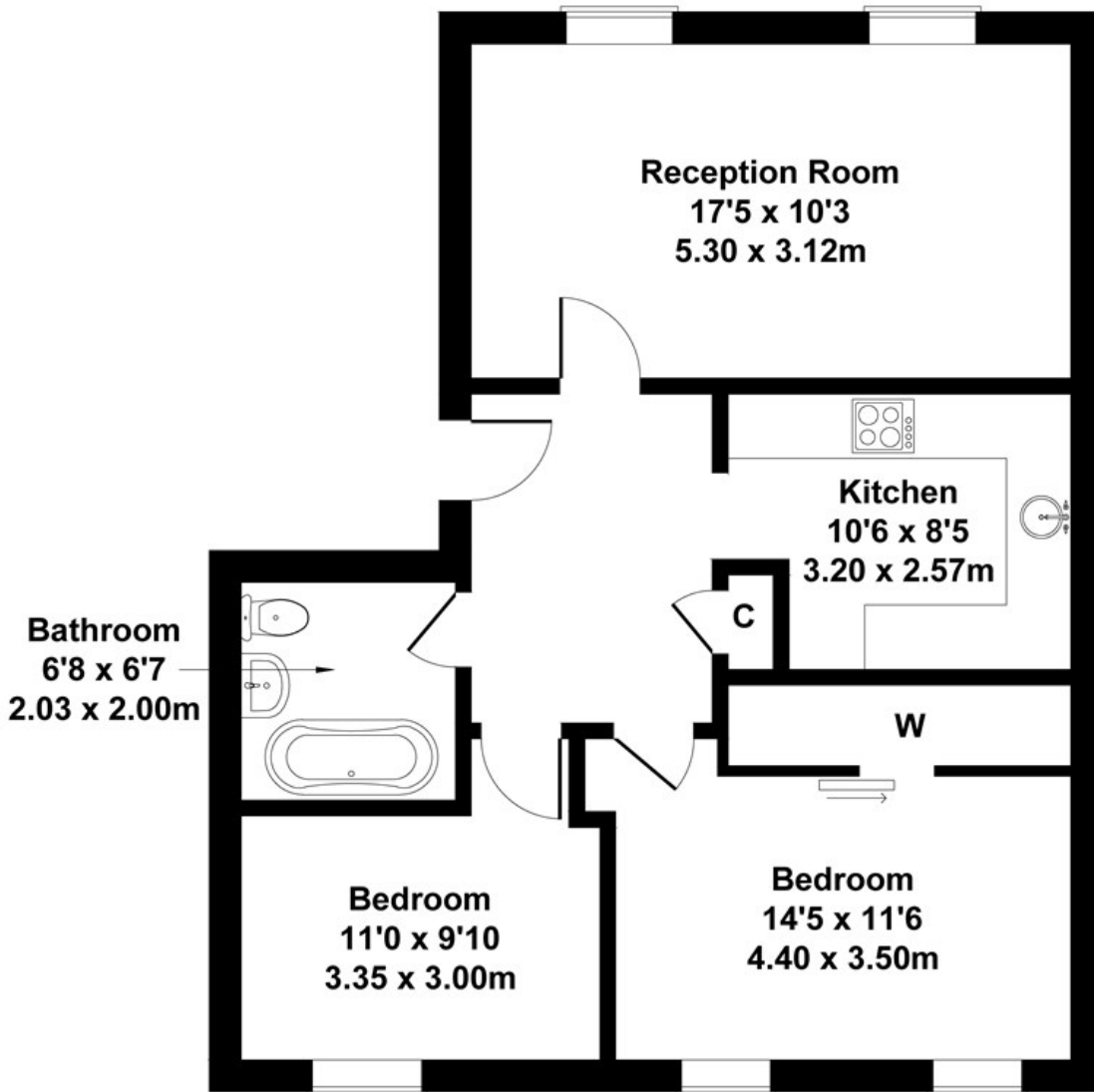
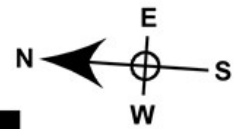

GROUND FLOOR

Not to Scale. Produced by The Plan Portal 2023
For Illustrative Purposes Only.

Energy Efficiency Rating		Current	Potential
Very energy efficient - lower running costs			
(92 plus) A			
(81-91) B			
(69-80) C		69	76
(55-68) D			
(39-54) E			
(21-38) F			
(1-20) G			
Not energy efficient - higher running costs			
England & Wales		EU Directive 2002/91/EC	